



Apartment

# FLAT 7 PURDY HOUSE, 150 KING STREET, GREAT YARMOUTH, NR30 2PA

PCM

## £800 PCM

### FEATURES

- Town Centre
- Modern Living
- EPC Rating D
- Double Bedroom
- Open Plan
- Council Tax Band A



# 1 Bedroom Apartment located in Great Yarmouth

Introducing this one bedroom apartment located in the heart of the town centre, this location is surrounded by many local amenities and within walking distance to main transport links. The apartment itself is located on the first floor and comes complete with one double bedroom, open plan living, balcony and modern bathroom. This property has no parking.

Call us on  
01603 338433

[norwich@thinkproperty.ltd](mailto:norwich@thinkproperty.ltd)  
<https://www.thinkproperty.ltd/>

Council Tax Band  
**A**

GROUND FLOOR

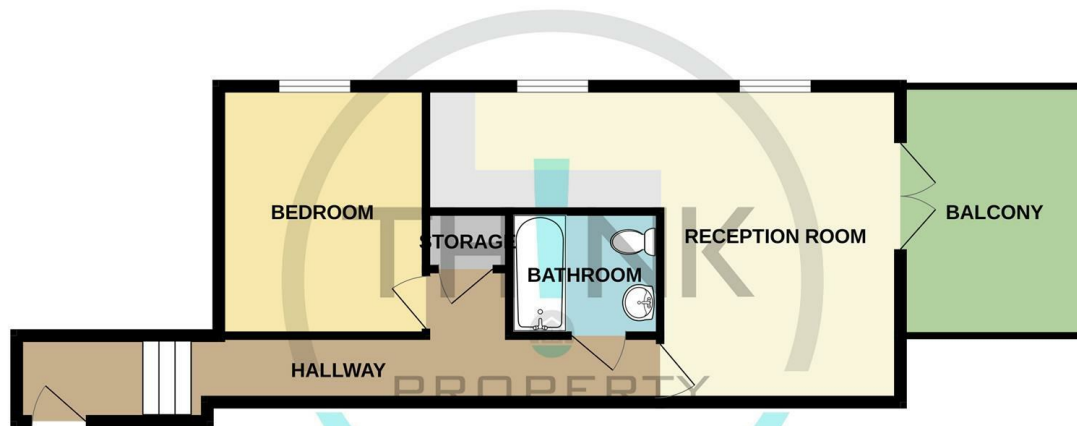

Whilst every attempt has been made to ensure the accuracy of the floorplan contained here, measurements of doors, windows, rooms and any other items are approximate and no responsibility is taken for any error, omission or mis-statement. This plan is for illustrative purposes only and should be used as such by any prospective purchaser. The services, systems and appliances shown have not been tested and no guarantee as to their operability or efficiency can be given.  
Made with Metropix ©2024

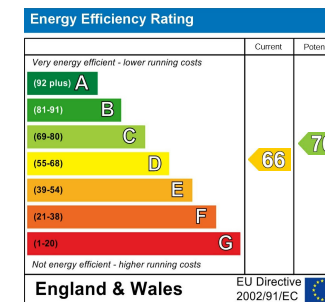

Agents Note: Whilst every care has been taken to prepare these particulars, they are for guidance purposes only. All measurements are approximate and are for general guidance purposes only and whilst every care has been taken to ensure their accuracy, they should not be relied upon and potential buyers are advised to recheck the measurements.

